



22 Leafield Road, Oxford, OX4 2PL

£1,875 - 20th December 2025

- Three bedroom semi detached house
- Gas CH
- Off street parking
- Surface flood risk LOW, General flood risk VERY LOW
- Unfurnished
- Rear garden
- Council tax band D
- Excellent condition throughout
- Single garage and off street parking
- EPC rating D

22 Leafield Road, Oxford OX4 2PL

Located in the popular area of Temple Cowley, this three bedroom house has been fully redecorated and is in excellent order throughout. Very convenient for access to Science Parks, City Centre and Ring Road. Available unfurnished. Two double bedrooms, Single bedroom, Bathroom with shower over, downstairs W/C, Living/Dining room with French Doors to rear garden, Fully fitted Kitchen with electric oven, hob, fridge/freezer and dishwasher. Cloakroom. Gas CH. Rear garden. Garage and off street parking.



Council Tax Band: D



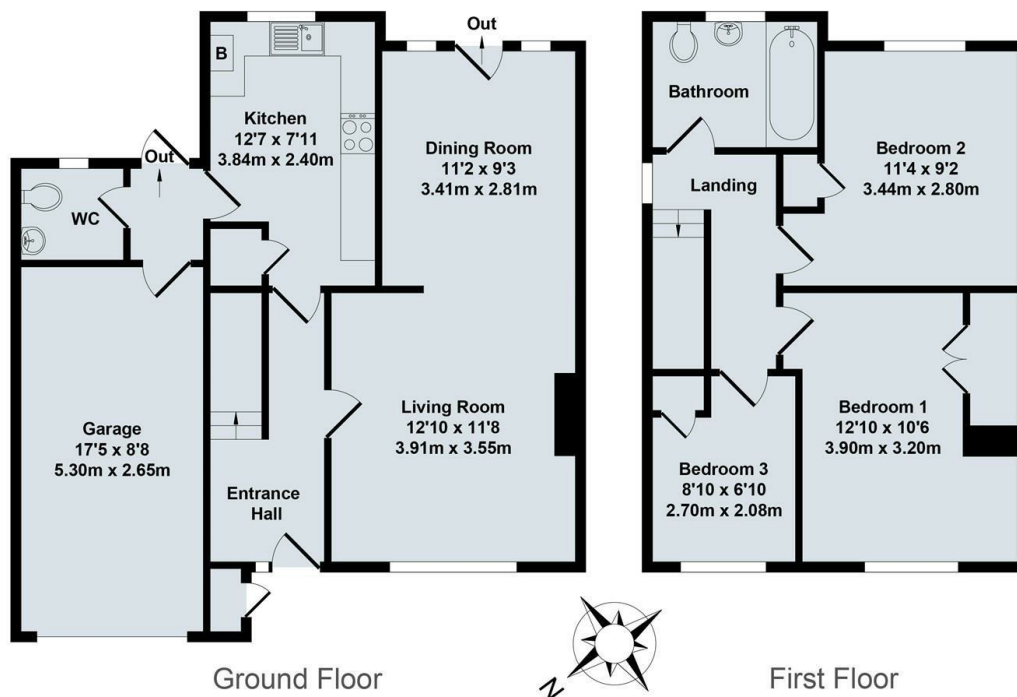

Total Approx. Floor Area 1074 Sq.Ft. (99.80 Sq.M.)

All items illustrated on this plan are included in the "Total Approx Floor Area"

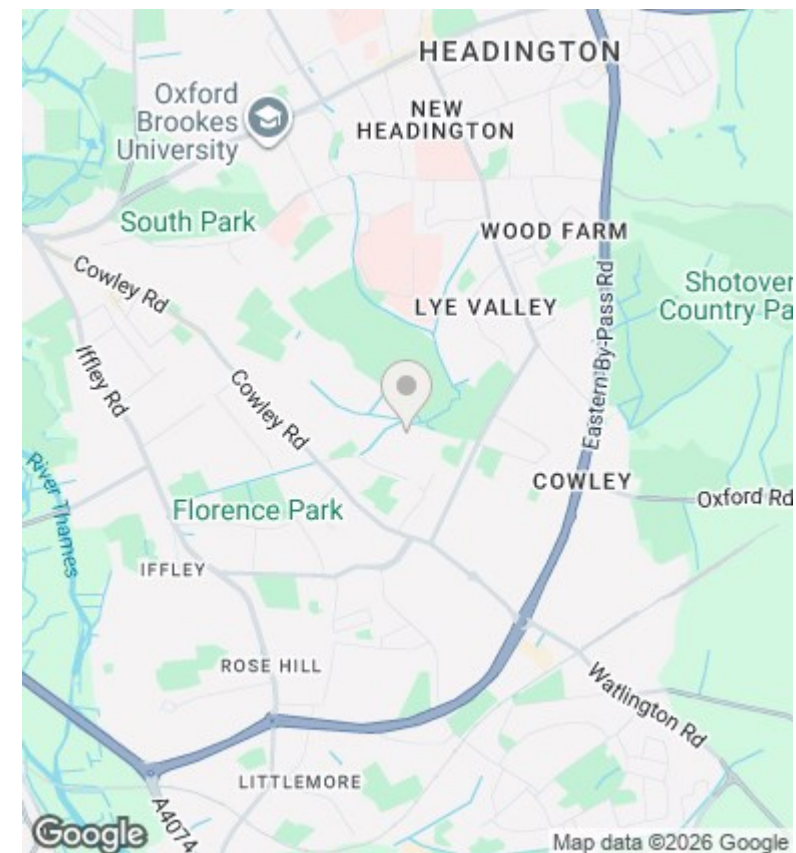

Directions

Viewings

Viewings by arrangement only. Call 01865 515900 to make an appointment.

Council Tax Band

D

Energy Efficiency Rating		
	Current	Potential
Very energy efficient - lower running costs		
(92 plus) A		
(81-91) B		84
(69-80) C		
(55-68) D	63	
(39-54) E		
(21-38) F		
(1-20) G		
Not energy efficient - higher running costs		
EU Directive 2002/91/EC		
England & Wales		